

Tender No. : 01/CS/2014
Name of work : Supply, Installation, Commissioning, Facility Construction & Maintenance of Drive-through Container Scanner (Road)
Subject : Clarifications to site related queries/issues raised in pre-bid meeting – Mundra Port Site

A pre-bid meeting in respect of above mentioned tender was held on 05/08/2014 in the office of Commissioner, Directorate of Logistics (DOL), New Delhi. In the meeting, prospective participating bidders had raised certain queries related to Mundra site. As these queries could be well addressed at site, the bidders were advised to visit the site of installation of the drive-through container scanner and also that a meeting will held in Mundra on 09/08/2014 to answer bidders' queries upon site visit.

2. Accordingly, the meeting was held on 09/08/2014 at 15.00 hrs. in Conference Room of Mundra Port, which was attended by the representatives of Mundra Port authorities, user Commissionerate, Directorate of Logistics, M/s Rapiscan and M/s Smith Detection, A visit to the site of installation of Drive-through Container Scanner (Road) was also organized.

3. Clarifications to the queries/ issues raised by prospective bidders in the pre-bid meeting of 05/08/2014 and after the site visit are provided below:

S. No.	Queries/Issues	Clarifications/Response
1	Clearances & Approvals	
	(i) Whether CRZ regulations currently applicable for the proposed construction of the Facility? Any approval required?	Proposed site for locating scanner facility for import container is out of CRZ area. However, the site is located in SEZ of Mundra Port.
	(ii) What all approvals/ clearances required from Port authorities?	Port has already allocated land for import container scanner and the same has been communicated to Commissioner, Customs.
	(iii) Any clearance required from terminal operator?	There is no separate terminal operator. Hence, not applicable.
	(iv) Approvals from any other local authorities/ bodies	Presently, approvals of Development Commissioner, SEZ and Gujarat Pollution Control Board will be required.
2	Influence of Local Bodies	
	Are there any influences of the Local bodies to carry out the execution activities at site?	Presently, no known influence of local bodies to carry out the execution activities at site. Bidder can carry out the construction activities as per his arrangement.
3	Existing underground services	
	Are there any underground services/ cables, etc. running through the plot?	There is no known existence of underground services, pipe lines, cables, etc. running through plot.
4	Geo-technical investigation	
	Are there any geo-technical report pertaining to the site for scanner installation available?	Bore-hole location and data as available with Mundra Port is attached. However, Bidder is advised to carry out geo-technical investigation of the scanner plot in order to obtain the details of underground strata and to decide on founding level and foundation design.
5	Foundation	
	(i) Type of foundation for nearby existing building?	Pile foundation; however, it is dependent of loading pattern of proposed structure.

	(ii)	Any recommended foundation for scanner facility.	Pile foundation; as the SBC at suggested location is only around 2.5 to 3 tons/ sq.mtr.
6	Plinth level		
	(i)	Highest flood level	Away from flooding area, however, for nearby areas highest tide level is +6.7CD.
	(ii)	Level of approach roads	Existing approach road finished ground level is around +8.26 CD, therefore, suggested finished general ground level in this area is between 8.5 to +8.8 CD. Scaled AutoCAD drawing of the zone of interest is attached.
	(iii)	Drainage condition	Presently, there is no drainage existing at site. It will need to be designed by the Bidder and communicated to Mundra Port for further connection.
7	Debris clearance		
	(i)	All debris available before, during and after construction which is encountered will be cleared and deposited with lead and lift at the designated locations shown by the respective port authorities.	Debris has to be dumped at a designated area (within a distance of about 4 km) earmarked by Port, on chargeable basis.
	(ii)	Any dumping charges will be levied the Port?	Charges will be communicated separately by Mundra Port as per the characteristics of debris to be disposed.
8	Water supply		
	(i)	Will adequate quantity of daily drinking water supply be made available by the Port Authorities during construction period and maintenance of the facility as a whole?	Adequate water for public health services & drinking has to be procured from Mundra Utility Pvt. Ltd. (MUPL, a separate company dealing with SEZ units' utilities supply). Water will be supplied by MUPL during the construction and operation of the facility on chargeable basis.
	(ii)	Any need for underground storage of water in scanner facility?	It is suggested to have 10KL water tank as per water demand of the proposed facility. Dead water storage for fire-fighting purpose, if required, shall be separately planned by the Bidder.
	(iii)	Whether the contractor has to make his own arrangement for construction related water?	Yes. MUPL shall provide water tapping on chargeable basis, however, pipe line laying and related cost has to be borne by the Bidder. Length of proposed pipeline is around 250 running meter and it is suggested to have 50 mm diameter water pipeline connectivity. The work of laying the pipeline can also be undertaken by MUPL on behalf of the Bidder, albeit on chargeable basis.
9	Storm water drain		
		Location of nearest storm water drain at the site of the scanner installation to which the discharge from the facility to be connected?	Storm water arrangement within the scanner facility will be made by the Bidder. However, external connectivity beyond scanner facility boundary to the ultimate discharge point will need to be made by Mundra Port.
10	Fire water line		
		Nearest location of fire-line to which the contractor will connect ring main of the scanner facility?	There is no fix fire-fighting system in this area; hence ring-main connection with Port FFS line is not possible. However, Port has its own fleet of fire tenders which is just 5 km away from this proposed

			facility and can be used on chargeable basis.
11	Electrical power		
	(i)	During construction of the facility?	For construction activities, power has to be procured on chargeable basis from MUPL. However, for the same Bidder shall have to lay around 250 running meter cable. MUPL can undertake this work on behalf of the Bidder, albeit on chargeable basis.
	(ii)	During regular operation of the facility?	For Operation & Maintenance of the scanner and facility, MUPL will provide power at 11 KV. Bidder shall have to lay around 50 running meter cable for the same and construct a sub-station. MUPL can also undertake this work on behalf of the Bidder, albeit on chargeable basis.
	(iii)	Need to establish a sub-station by the scanner supplier?	As the power supply for O&M will be at 11 KV, Bidder will have to set-up a sub-station as per the requirement.
	(iv)	Distance of source for supply?	Around 50 meters. However, the bidder can make their own assessment of cable lengths.
12	Site management:		
	(i)	Is it possible to set up labour camp near to site or inside SEZ area?	No labour camp in SEZ area allowed. However, construction work can be carried out on 24 x 7 basis, if required.
	(ii)	For men-movement any permission required?	Entry permit for men & material movement will need to be taken from SEZ main gate, as per existing procedure.
	(iii)	Any special permission required for foreign visitors?	For foreign visitors, additionally permission of Customs will need to be taken, for which normally three days lead time is desirable.
	(iv)	Can space for temporary office / storage shed be provide outside construction area, if need be?	Yes, on chargeable basis.
13	Hot work' permit		
		For welding, gas cutting etc. during construction will prior permission of Port Authorities required?	No such requirement exists. However, the Bidder will need to follow site safety procedure during construction.
14	Entry & exit roads		
		Will Port authorities construct the roads leading to and from the scanner facility?	Mundra Port has sought that the entry and exit roads to be constructed by the Bidder, however, these roads will be maintained by Mundra Port on long term basis, free of any charges and carries out relaying, whenever required. Scaled AutoCAD drawing of the zone of interest is attached.

MUNDRA PORT SCANNER LOCATION MAP:

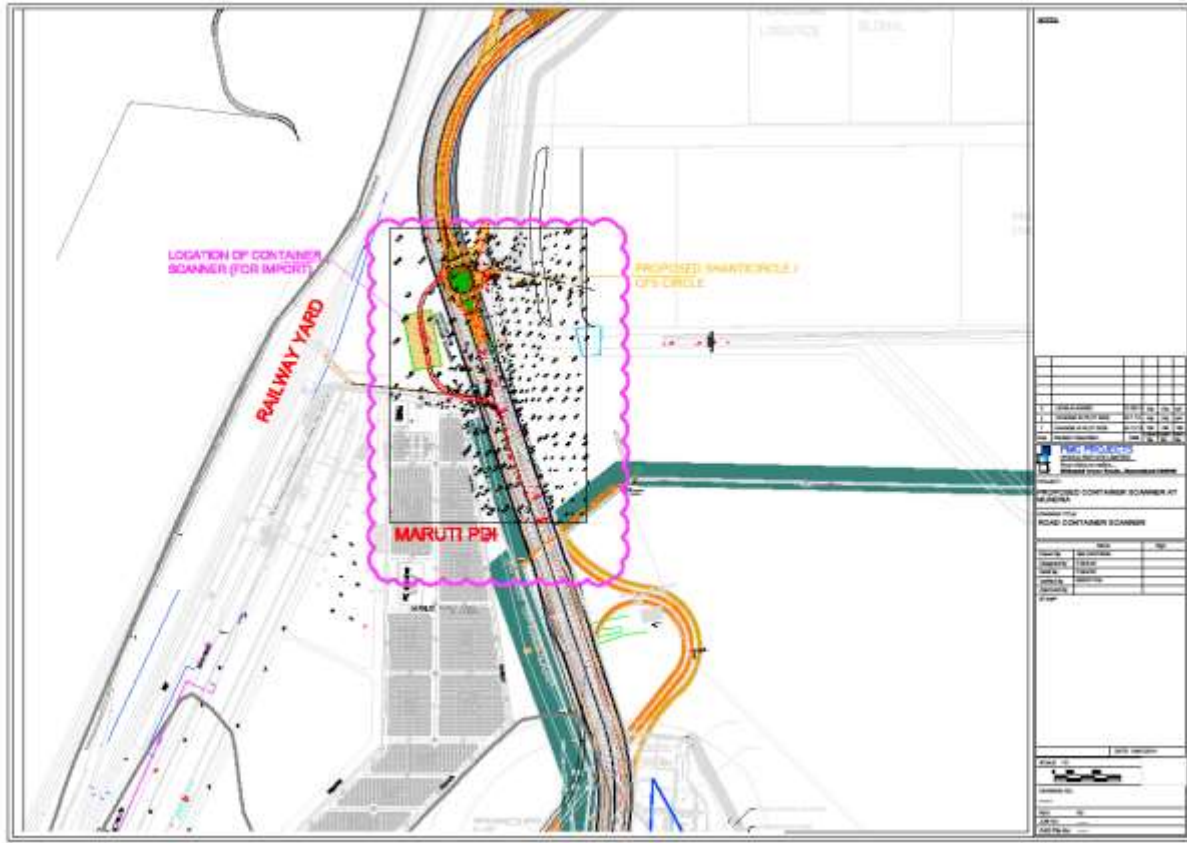

Bore Hole Drawings of Mundra site:

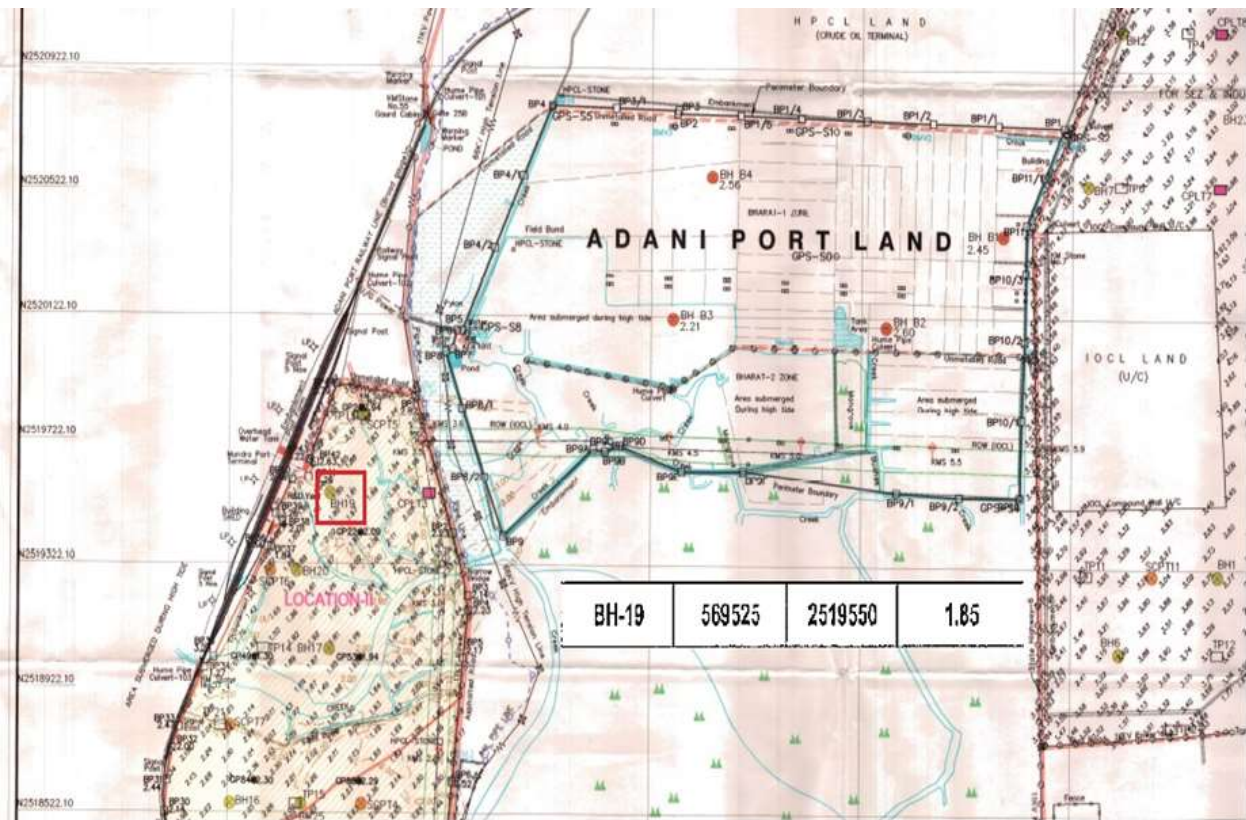

SOIL DATA AND BORE LOG

BORE LOG									
PROJECT : GEOTECHNICAL INVESTIGATIONS FOR MUNDRA SPECIAL ECONOMIC ZONE (CONTAINER TERMINUS & RELATED FACILITIES)			TYPE OF BORING : ROTARY			BORE HOLE DIA. : 150mm			
CLIENT : MUNDRA SPECIAL ECONOMIC ZONE LIMITED			SWT FROM G.L. : 0.90 ABOVE EGL (HT)			CASING DEPTH : -			
BORE HOLE NO. : BH-19			DATE OF COMMENCEMENT : 03.05.04			DATE OF COMPLETION : 04.05.04			
LOCATION : 650 acres area (Referred as Location II)									
DEPTH BGL FROM G.L. (m)	ENGINEERING CLASSIFICATION	TYPE OF SAMPLING	STANDARD PENETRATION TEST NO. OF BLOWS FOR				ROCK DRILLING CORE RECOVER RY (%)	RQD (%)	REMARKS
			FIRST 15 cm (N ₁)	NEXT 15 cm (N ₂)	NEXT 15 cm (N ₃)	TOTAL (N ₁ + N ₂ + N ₃)			
1.00	Brownish grey clayey silt	DS							
2.00		SPT	3	5	7	12			
3.00									
4.00		SPT	4	6	8	18			
5.00									
6.00	Blackish grey silty sand with traces of clay	SPT	7	9	10	16			
7.00		SPT	8	9	11	20			
8.00									
9.00		SPT	9	11	12	22			
10.00		SPT	9	12	14	26			
11.00									
12.00		SPT	11	10	14	27			
13.00									
14.00	Blackish grey silty sand with patches of clay	SPT	13	15	17	32			
15.00		SPT	13	13	15	28			

SPT = STANDARD PENETRATION TEST
DS = DISTURBED SAMPLE

BH Terminated at 15.00
UGSD/S Representative sample

SECON SURVEYS PVT LTD

